

Übersichtslageplan

vom 25.07.2014 zum ursprünglichen Bauantrag

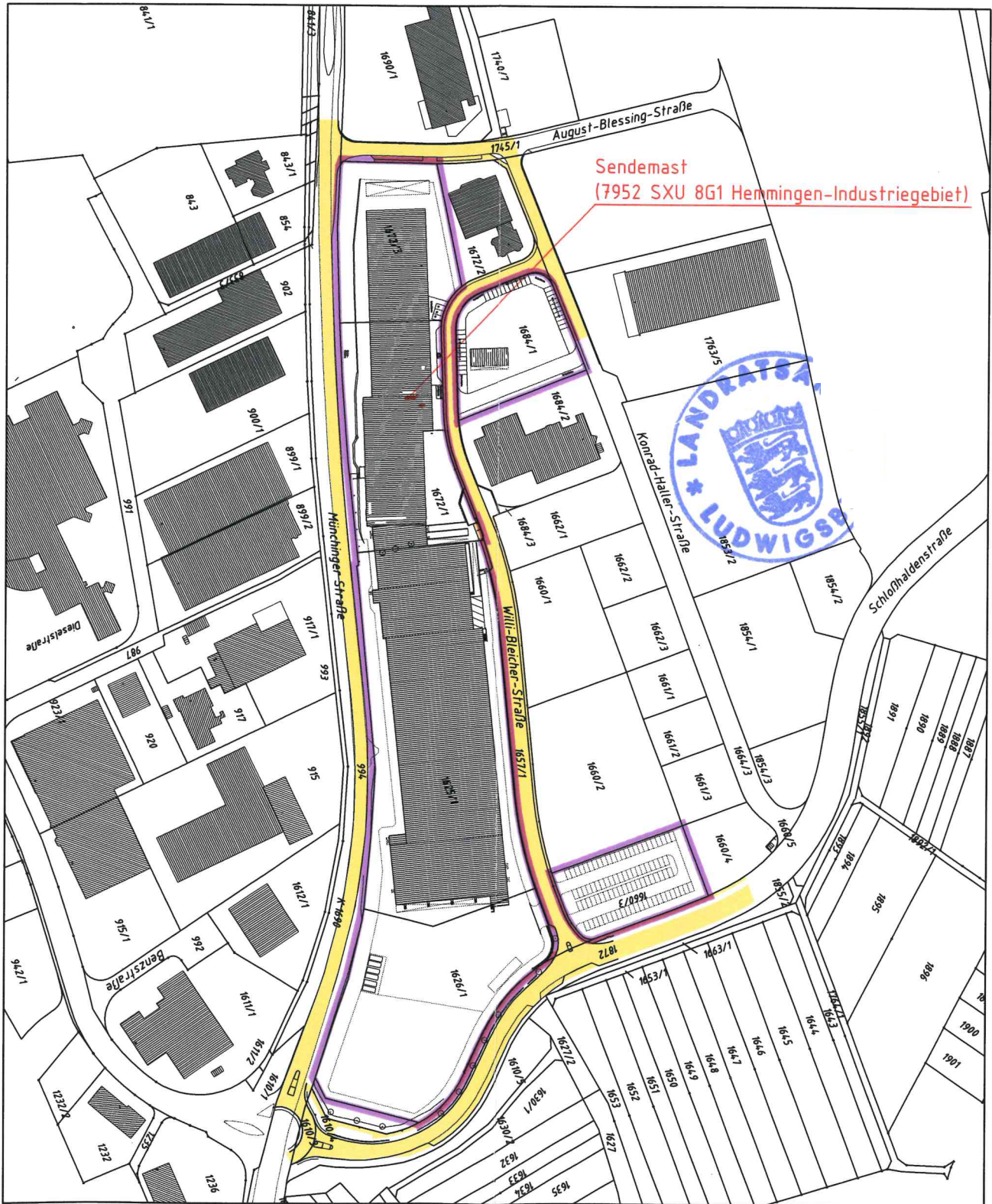
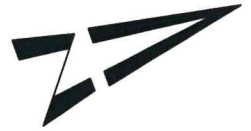

Maßstab 1:3000

Nordansicht

+ 26.04m
OK AT neu

+ 22.25m
CL Rifu 3 Opt.
+ 20.00m
CL Rifu 1 Neu

+ 23.90m
UK Triple 1-3
UK GSM 1-3

+ 21.85m
CL Rifu 2 Opt.

19.25m

Systemtechnik VF D2

+ 15.78m

HELUKABEL

+ .00m

